

# TIGER

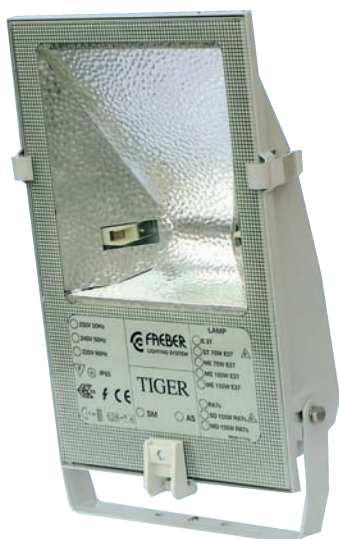

# TIGER



- I** Proiettori per interno/esterno per lampade MT/ST E40.  
Corpo in alluminio pressofuso verniciato nero e schermo incernierato in vetro temperato pressato su guarnizione in silicone espanso. Clips in estruo d'alluminio anodizzato naturale.  
Riflettori simmetrici (SM) e asimmetrici (AS) in alluminio martellato. Staffa di fissaggio in acciaio zincato con indice per goniometri di puntamento.  
Pressacavo PG 13.5 in PA 66 grigio.  
Accessori frangiluce (FRL-Y), deflettore (DFL-Y) in acciaio verniciati neri, griglia di protezione zincata (GRL-Y); staffa per fissaggio a soffitto (ST-YL) e staffa in acciaio inox (ST-YX). Ved. pag. 134
- GB** Floodlight for indoor/outdoor suitable for lamps MT/ST E40. Body in die-cast painted in black and hinged tempered glass pressed on silicone gasket.  
Clips in extrusion of aluminium, natural anodized. Symmetrical reflectors (SM) and asymmetrical reflectors in hammered aluminium.  
Fixing bracket in galvanized steel with index for aiming goniometer.  
Cable gland pG 13.5 in PA 66 colour grey.  
Glare control grid (FRL-Y), baffle (DFL-Y) in steel painted in black, galvanized protection grid (GRL-Y), ceiling fixing bracket (ST-YL) and stainless steel bracket (ST-YX). See pag. 134
- E** Proyectores para interior/exterior para lámparas MT/ST E40.  
Cuerpo en aluminio fundido a presión pintado en color negro y difusor fijado con bisagras en vidrio templado prensado sobre junta en silicona expandida.  
Clips en extrusión de aluminio anodizado natural.  
Reflectores simétricos (SM) y asimétricos (AS) en aluminio martillado.  
Lira de fijación en acero zincado con indicador para goniómetros de apuntamiento.  
Prensaestopa PG 13.5 en PA 66 gris.  
Accesorios difusor lamas (FRL-Y), deflector (DFL-Y) en acero pintados en color negro, rejilla de protección zincada (GRL-Y), lira para fijación a techo (ST-YL) y lira en acero inox (ST-YX). Veer pag. 134
- F** Projecteurs pour intérieur/extérieur pour lampes MT/ST E40.  
Corps en aluminium moulé sous pression peint en noir et écran fixé par charnière en verre tempéré pressé sur joint en silicone dilaté.  
Clips en aluminium extrudé anodisé naturel.  
Réflecteurs symétriques (SM) et asymétriques (AS) en aluminium martelé.  
Étrier de fixation en acier zingué avec index pour goniomètres de pointage.  
Presse-étoupe PG 13.5 en PA 66 gris.  
Accessoires grille de défilement (FRL-Y), visière (DFL-Y) en acier peints en noir, grille de protection zinguée (GRL-Y), étrier pour fixation à plafond (ST-YL) et étrier en acier inox (ST-YX). Voir pag. 134
- P** Projector para interior-exterior para lâmpada MT/ST E40.  
Corpo em alumínio pintado de cinzento RAL 9006, com vidro temperado e prensado sobre guarnição em silicone.  
Fechos em alumínio extrudido anodizado natural.  
Reflector simétrico (SM) ou assimétrico (AS) em alumínio martelado.  
Alça de fixação em aço zincado com goniómetro.  
Bucim PG 13.5 em PA 66 cinzento.  
Grelha anti-encadeamento (FRL-Y), deflector (DFL-Y) em aço pintado de preto, grelha de protecção zincada (GR-Y); alça de fixação a tecto (ST-YL) e alça em aço inox (ST-YX). Ver pág. 134
- D** Innen- und Außenraumscheinwerfer für MT/ST E40 - Lampen .  
Gehäuse aus druckgegossenem, schwarzlackiertem Aluminium und aufklappbarer Schirm aus getempertem, an einer Dichtung aus Silikon-schaumstoff geprefltem Glas .  
Klemmen aus fließgepreßtem, natureloxiertem Aluminium  
Symmetrische (SM) und unsymmetrische Lichtschirme (AS) aus gehämmertem Aluminium.  
Befestigungsbügel aus verzinktem Stahl mit Skale für Richtgoniometer.  
Kabelhalter PG 13,5 aus grauem PA 66.  
Lichtbrecher als Zubehör (FRL - Y) und Ablenker (DFL - Y) aus schwarzlackiertem Stahl und verzinktes Schutzgitter (GRL - Y); Wandbefestigungsbügel (ST - YL) und Bügel aus rostfreiem Stahl (ST - YX). Auf Seite 134 sehen.

## TIGER 70 SM

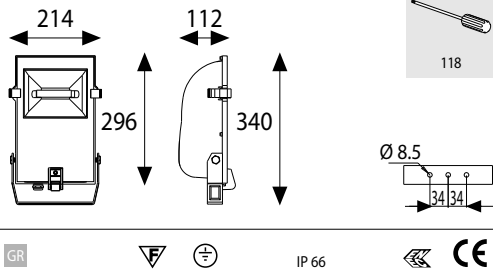

002110020	1xRX7s	RX7s	○	2.4
002116827	1x70 MD	RX7s	●	4.1
002115627	1x70 SD	RX7s	●	4.1

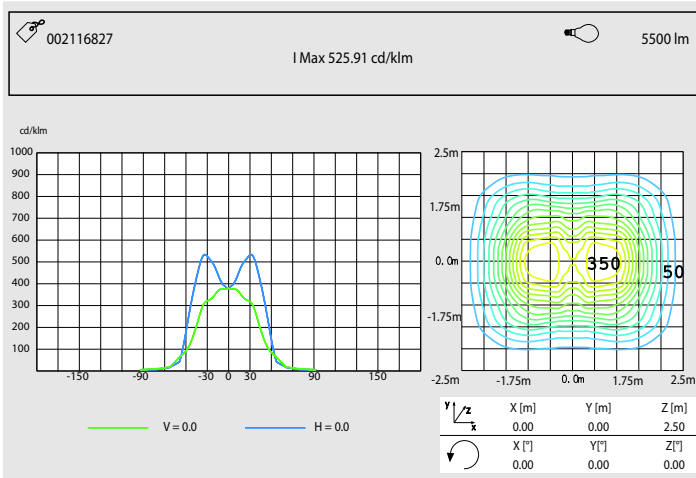

## TIGER 70 AS

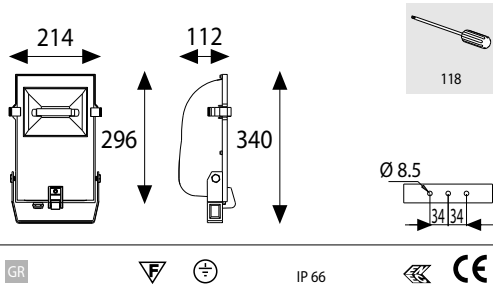

002100020	1xRX7s	RX7s	○	2.4
002106027	1x70 MD	RX7s	●	4.1
002105627	1x70 SD	RX7s	●	4.1

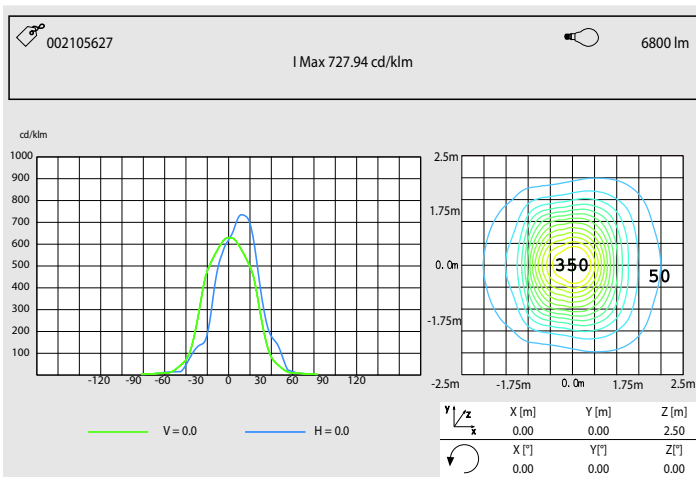

# TIGER

## TIGER 150 SM

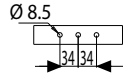
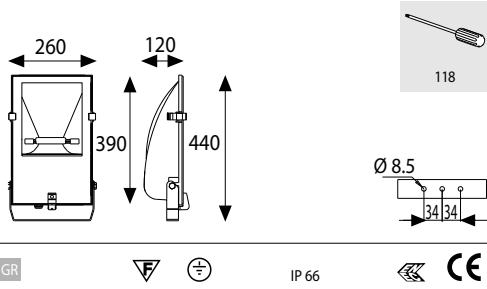

001910020	1xRX7s	RX7s	○	3.5
001917027	1x150 MD	RX7s	●	5.8
001916027	1x150 SD	RX7s	●	5.8

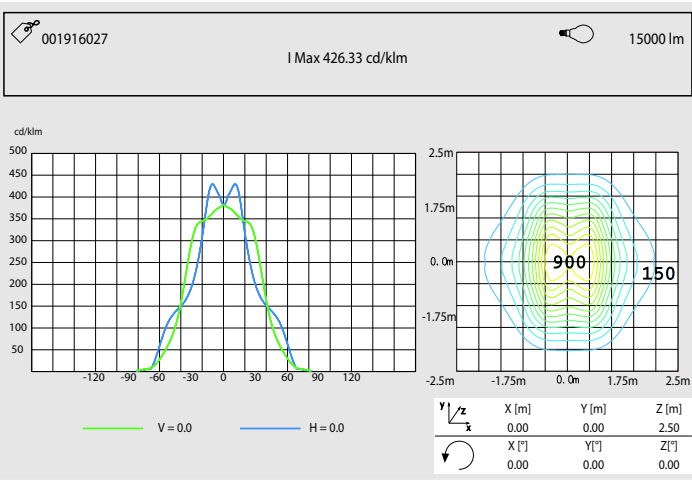

## TIGER 150 AS

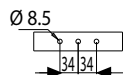
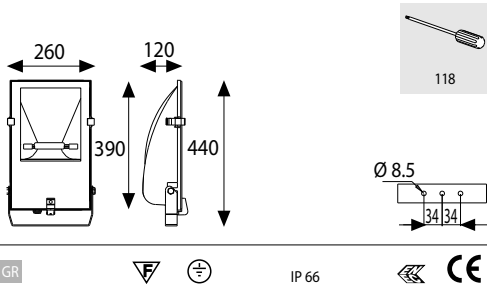

001900020	1xRX7s	RX7s	○	3.5
001907027	1x150 MD	RX7s	●	5.8
001906027	1x150 SD	RX7s	●	5.8

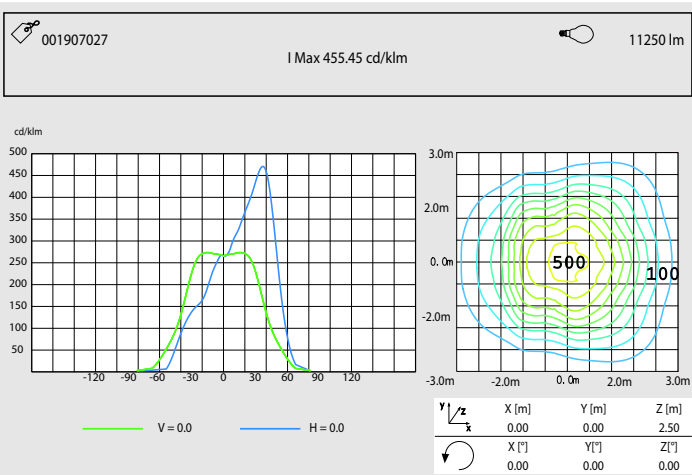

# TIGER

## TIGER 400 SM

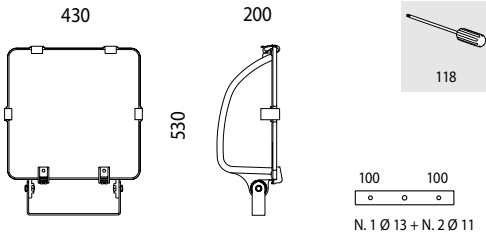

003030020	1xE40		E40	○	7.05
003036027	1x150 ST	△	E40	●	11.0
003036227	1x250 ST	△	E40	●	11.8
003036427	1x400 ST	△	E40	●	13.1
003037227	1x250 MT		E40	●	2.15A 11.0
003037427	1x400 MT		E40	●	3.4A 11.8

GR IP 66

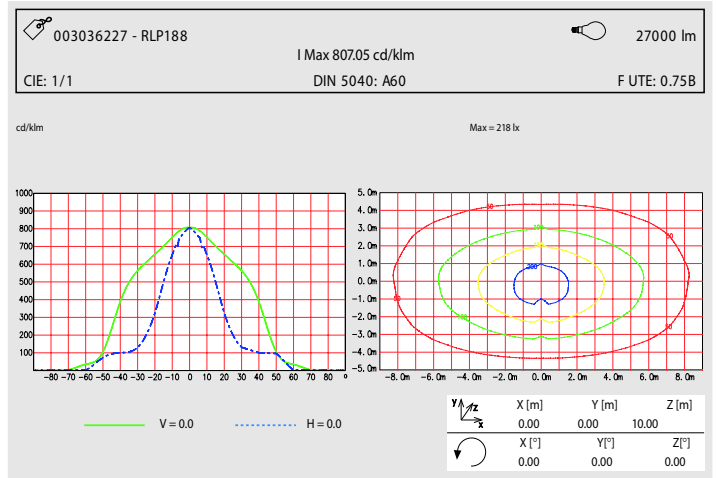
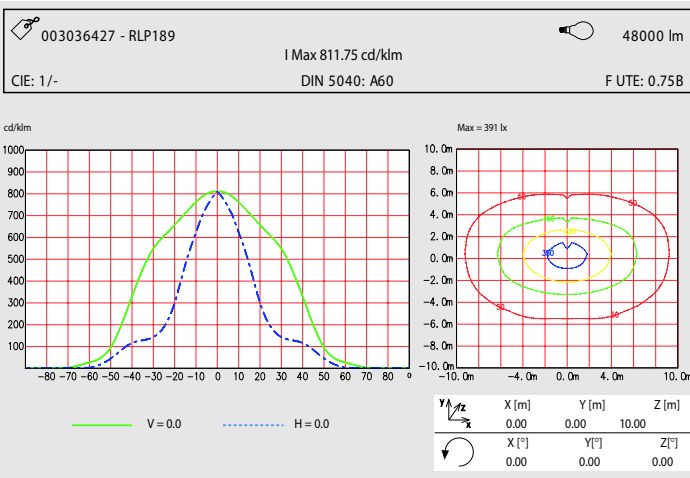

## TIGER 400 AS

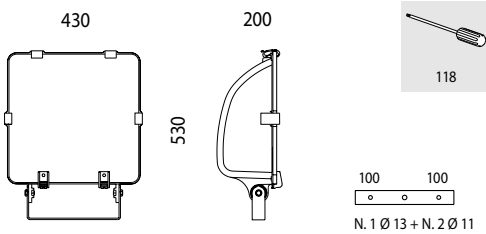

003020020	1xE40		E40	○	7.05
003026027	1x150 ST	△	E40	●	11.0
003026227	1x250 ST	△	E40	●	11.8
003026427	1x400 ST	△	E40	●	13.1
003027227	1x250 MT		E40	●	2.15A 11.0
003027427	1x400 MT		E40	●	3.4A 11.8

GR IP 66

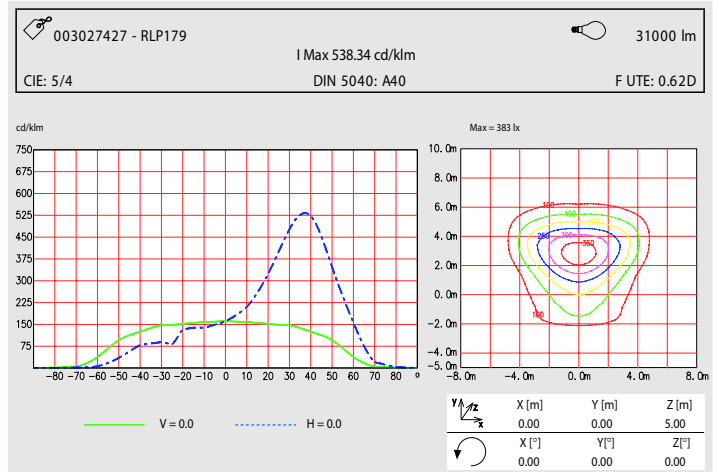
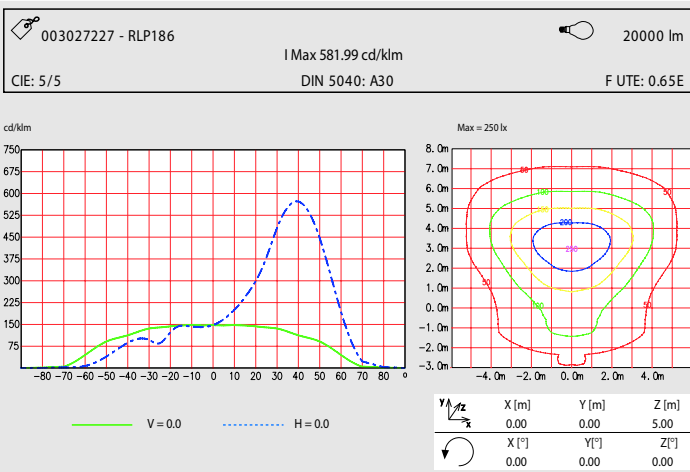

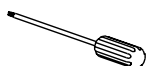

## TIGER FRL-Y - DFL-Y - GRL-Y

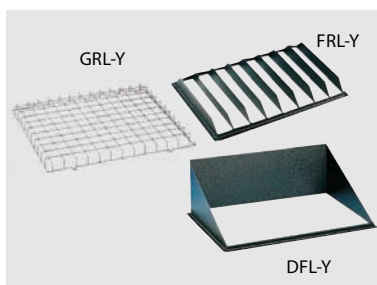

000090141	FRL-Y 400	2.3
000090142	DFL-Y 400	2.2
000090143	GRL-Y 400	1.4
000090148	FRL-Y 150	1.5
000063311	DFL-Y 150	1.4
000090147	GRL-Y 150	1.4
000090149	FRL-Y 70	1.0
000063451	DFL-Y 70	1.0
000090146	GRL-Y 70	0.8

NR ZN

## TIGER ST-YL supporto distanziatore - ceiling/Wall Fixing Bracket - soporte distanciador - support d'entroulement - braço - distanzst ckhalter

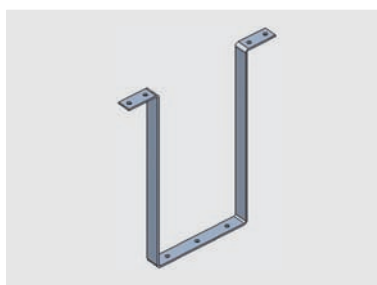
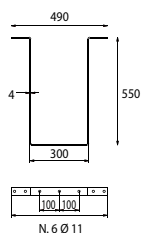

000040005	ST-YL	2.4
-----------	-------	-----

GR

## TIGER ST-YX staffa inox - stainless steel bracket - lira inox - etrier inox - alça em aço inox - bügel aus rostfreiem Stahl

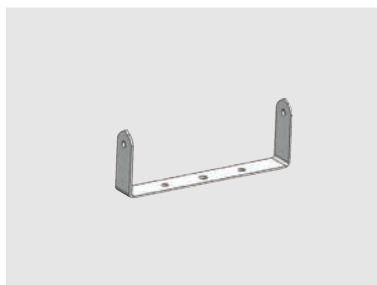
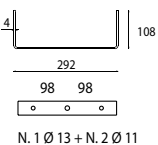

000040030	ST-YX	0.6
-----------	-------	-----

IN

## TIGER ST-YP staffa parete - stainless steel bracket - lira inox - etrier inox - alça em aço inox de parede - bügel aus rostfreiem Stahl

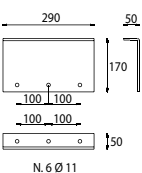

000040025	ST-YP	2.4
-----------	-------	-----

ZN

## TIGER ST-YXL

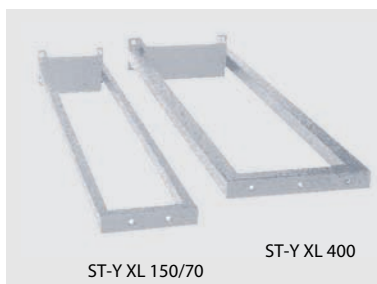

000040045	ST-YXL	4.6
GR Tiger 400		
000040050	ST-YXL	3.7
GR Tiger 150/70		
000040040	ST-YXL	4.6
NR Tiger 400		
000040035	ST-YXL	3.7
NR Tiger 150/70		

ST-Y XL 150/70

ST-Y XL 400